



Karndean
Designflooring



Korlok Wood

Floors with a Soul and a Story



Natural Koa RKP8122

Why Karndean?

At Karndean, we see flooring differently.

We travel the world in our quest to bring you exceptional floors that inspire and delight. From the ancient forests of Europe, to the remote Australian outback and beyond, we seek out expressive and intriguing forms in the natural world to influence our unique floor designs. By combining these original features with cutting edge design, we create simply beautiful floors that you'll love for a lifetime.

From Our Home...

It all began in 1973 when a former flooring installer created a small business from his family home.

With the belief that luxury vinyl flooring shouldn't just be practical, it needed to be beautiful as well, Karndean was formed. The team set out to travel the world, seeking inspiration from natural materials for what now are the most realistic luxury vinyl flooring products on the market.

The Karndean team worked out of that house for several years with the family's trusty dog Smokey, the Great Dane who is still present on Karndean's logo today. For the family and Karndean's early employees — many who are still working with us today — these years bring back many fond memories.

Now stretching across the globe, beyond the walls of the original house, the Karndean family and employees continue to move forward with the same passion to deliver beautiful, innovative designs for your home.





Braemar Oak RKP8238

...to Your Home

Designing your home can be overwhelming. There are many elements that must fit together, from furniture to flooring, to fixtures and everything in between. Where to begin?

We begin a new design with an inspiration, and we are most inspired by nature. What's your design motivation? Is it aesthetic, such as a throw pillow or the perfect paint chip? Or is it lifestyle, a place where you can dance in your pajamas and your babies (both two- and four-legged) can roll around and play?

No matter what drives you, Karndean was created with your needs in mind. We see flooring differently and by combining our original features with cutting edge design, you can create a simply beautiful floor that you will love for a lifetime.

Our simple method will help you navigate the selection process and design your perfect floor, taking you beyond picking a color and measuring the room. Let's get started!



Meet Marcos & Lotta

and find out how Karndean set the foundation for their home.

www.karndean.com/marcosandlotta

Create more than a floor,

Create a Designfloor

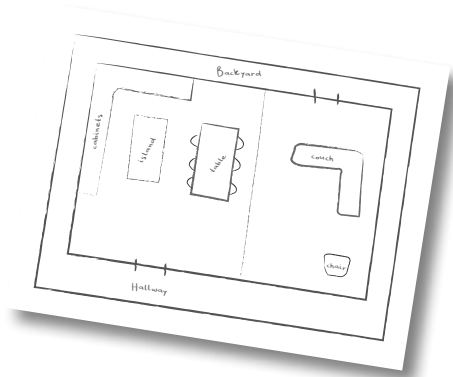

1

Imagine your space

Something as simple as drawing a picture of your space will put you in a creative mindset.



2

Design ideas

Take inspiration from our installation patterns guide to design your floor.



3

Which format and color?

We're sure to have a floor that fits your design style.

1. Imagine Your Space

Grab a piece of paper and start to draw your space by following the example below.

1. Start with the shape of your space and entry points.



2. Lay the floor in the direction you walk through the room.

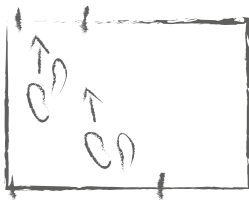

3. Are there any adjoining rooms?

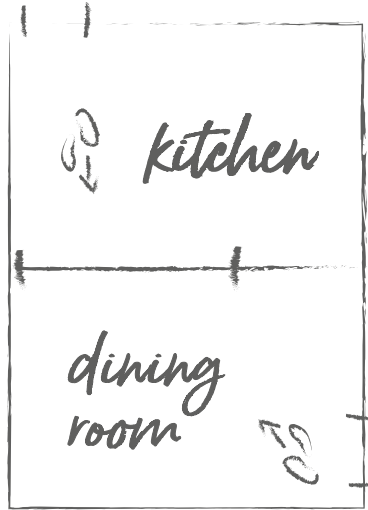

4. Sketch fixtures in your space.

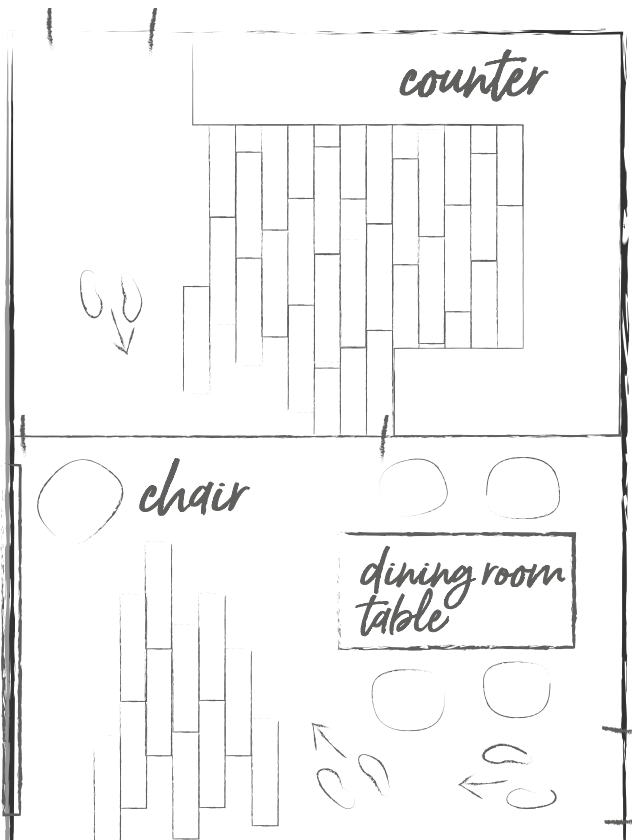
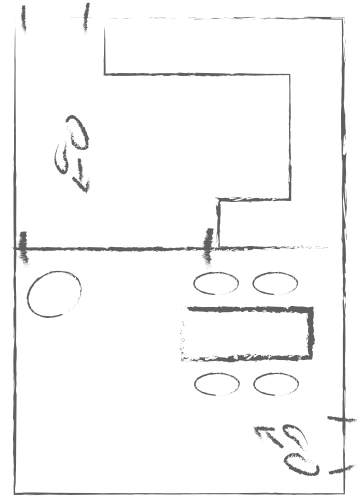

Take your space from sketch to reality.

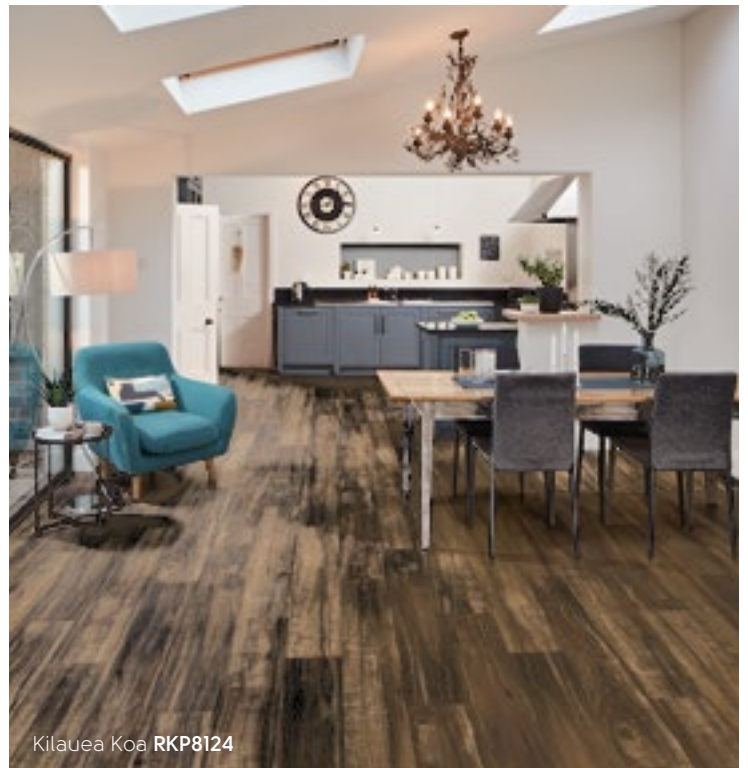

2. Design Ideas

Staggered

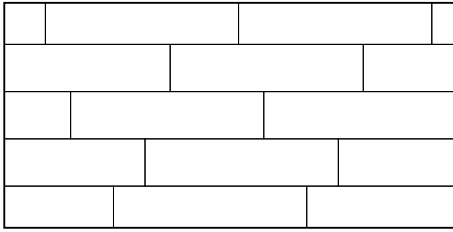

Diagonal

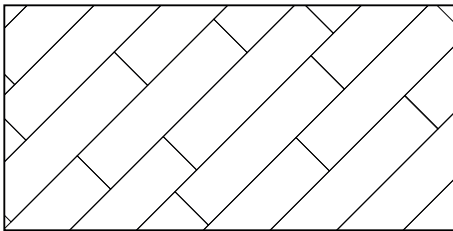

Herringbone

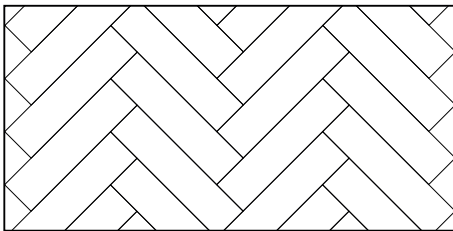

It's not just the floor you choose, but the direction you lay it that makes a lasting impression. Use our pattern guide for inspiration or to share with your local retailer.



Herringbone

This is a great lay pattern for spaces that have multiple footpaths and entryways

Salvaged Barnwood SM-RKP8209

3. Why Rigid Core?

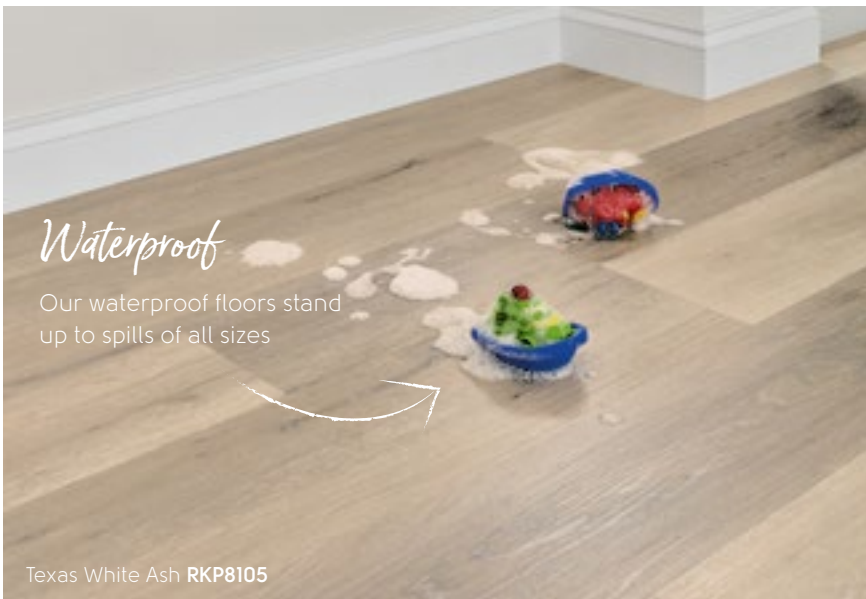





Waterproof

Our waterproof floors stand up to spills of all sizes

Texas White Ash RKP8105

Benefits of a rigid core floor?

-  **Floats over existing hard floors:** Rigid core can be floated over most existing hard floor coverings.
-  **Warm underfoot:** Our products are much warmer and more comfortable underfoot.
-  **Acoustic qualities:** The premium, pre-attached acoustic foam backing reduces noise transfer to rooms below.
-  **Quick and easy to install:** Click-locking systems allow the installer to quickly drop and lock planks together, meaning less upheaval and disruption to everyday life.

Choose Your Color

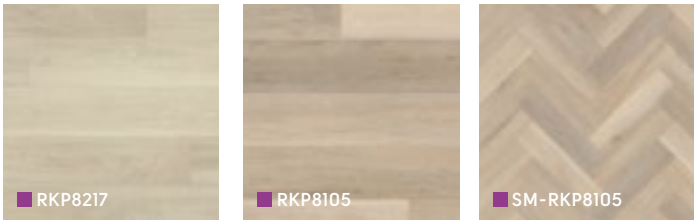

RKP8217

RKP8105

SM-RKP8105

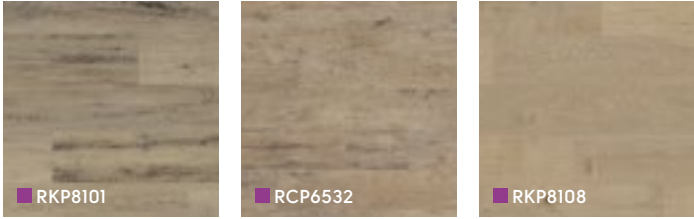

RKP8101

RCP6532

RKP8108

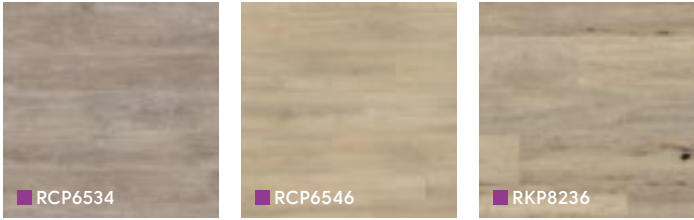

RCP6534

RCP6546

RKP8236

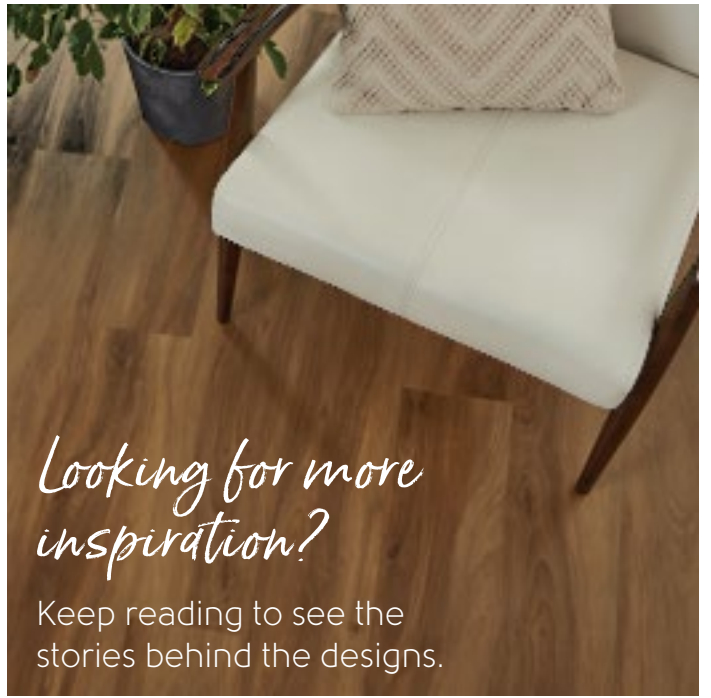

Looking for more inspiration?

Keep reading to see the stories behind the designs.

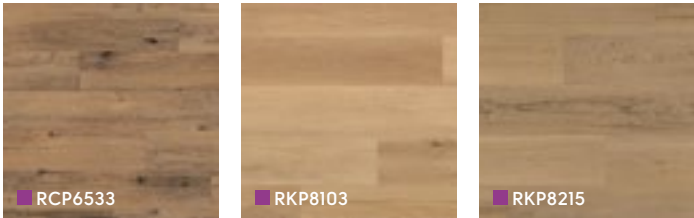

RCP6533

RKP8103

RKP8215

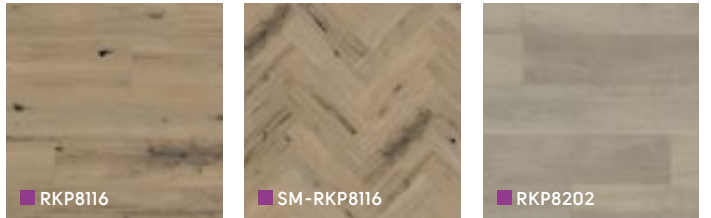

RKP8116

SM-RKP8116

RKP8202

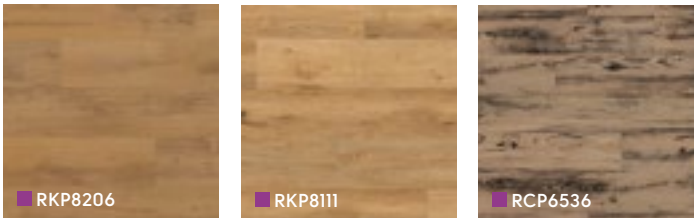

RKP8206

RKP8111

RCP6536

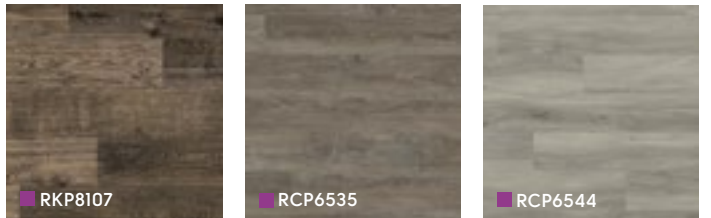

RKP8107

RCP6535

RCP6544

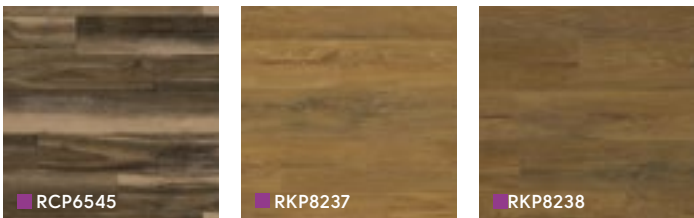

RCP6545

RKP8237

RKP8238

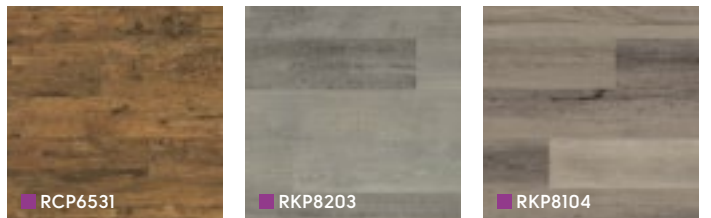

RCP6531

RKP8203

RKP8104

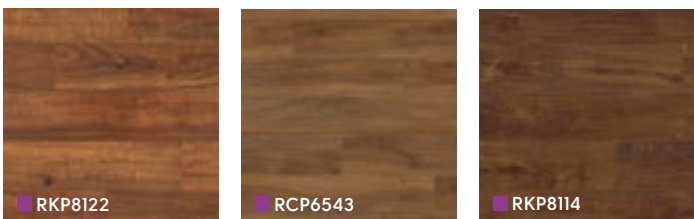

RKP8122

RCP6543

RKP8114

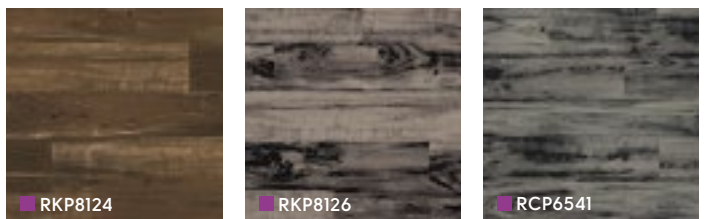

RKP8124

RKP8126

RCP6541

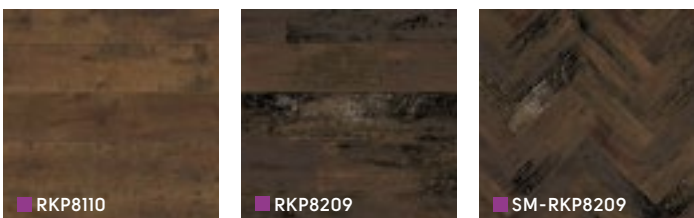

RKP8110

RKP8209

SM-RKP8209

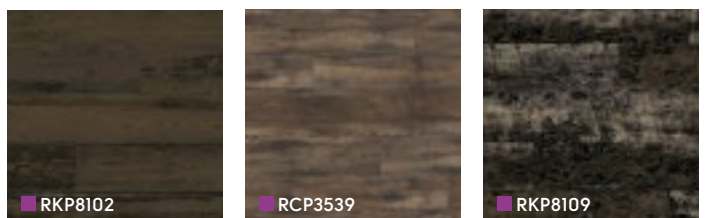

RKP8102

RCP3539

RKP8109



Focus on Style



Naturally Mid-Century

Warm Brushed Oak RKP8215



This style mixes the simplicity of mid-century with organic materials. The natural light beaming off the warm neutral flooring mimics the forest floor.

Need help finding your style?

Visit our Pinterest page [karndeanUSA](#)

Developed from a combination of straight and flowery grained European Oak boards, the delicate balance of grain found in Warm Brushed Oak cannot be found in natural hardwood. The grain, combined with its sandy coloring and distinct registered emboss, forms a subtle, neutral floor to coordinate with many home styles.



Focus on Style



Delicately Detailed

Ghost Elm RCP6544

A cool, detailed floor will balance a bold wall color to suit even the pickiest of teens!
Looking for design inspiration?
Follow us on Instagram @karndean_usa



This clean, yet characterful elm design creates distinctive floors that have depth and character, without overpowering a room. The cool grays of Ghost Elm will best suit contemporary or coastal interior styles.



Ghost Elm RCP6544



FRENCH OAKS

Sourced from boards dating back to 17th century French oak flooring, hundreds of years of natural wear have resulted in a worn and rustic design full of character and personality.



Behind the Design

Antique French Oak RKP8110

 = available in RIGID CORE product

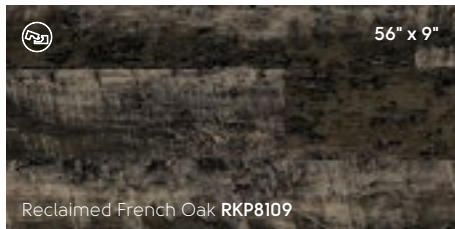

WASHED GREY ASH

This gray-tone plank offers a detailed design which will add impact to any space. Offering straight grain detailing and a lightly brushed appearance, this plank is a favorite among contemporary designers.

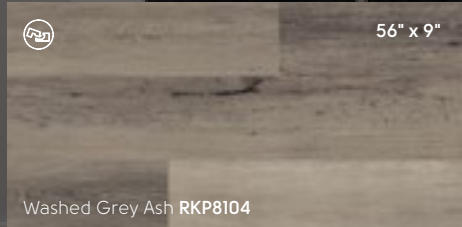

Smoky Greige

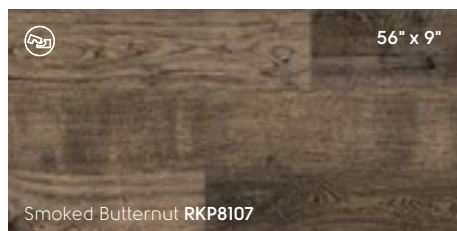
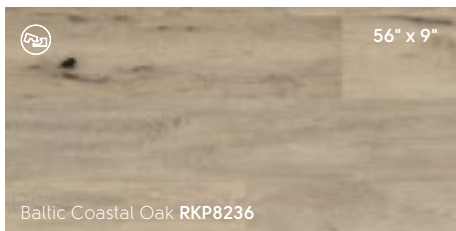

 = available in RIGID CORE product

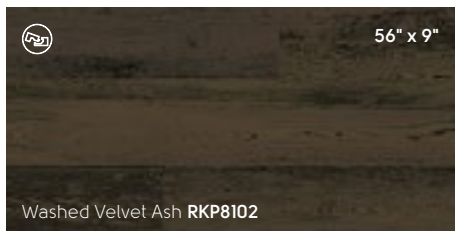
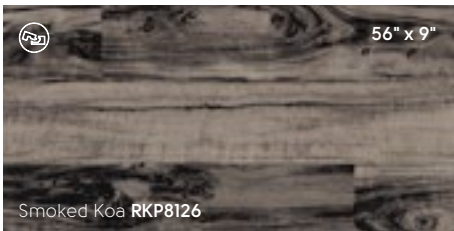

Text Us

Text the color number to
877-722-2086 to have a free
sample shipped to your home.

WASHED BUTTERNUT

Often referred to as "white walnut," we sourced planks from the eastern United States. Real butternut is even softer than walnut, making it highly impractical for flooring and, as a protected wood, difficult to find in its natural form.



56" x 9"

Washed Butternut RKP8108

Light Washed

 = available in RIGID CORE product

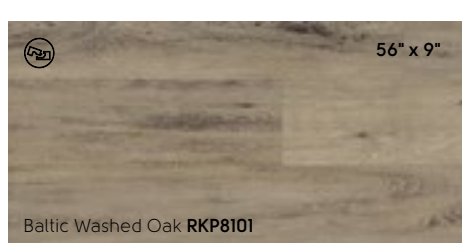
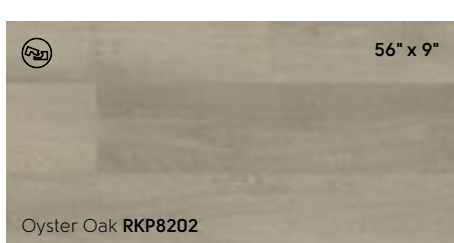
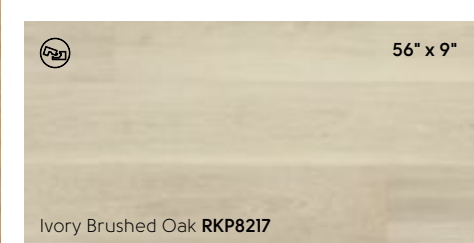
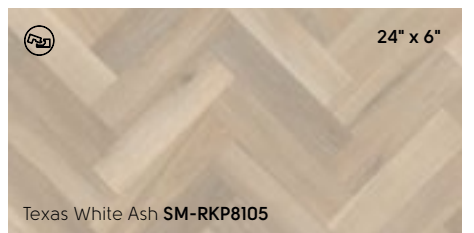
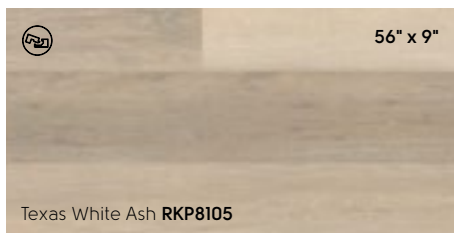



Light and Clean

Canadian Urban Oak SM-RKP8116

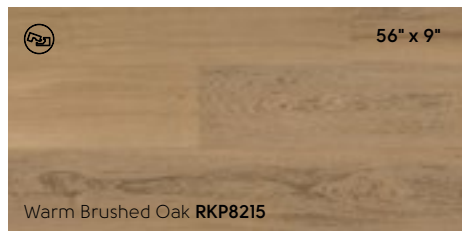
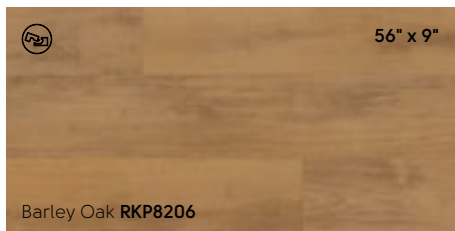
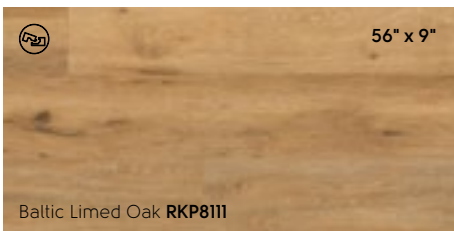
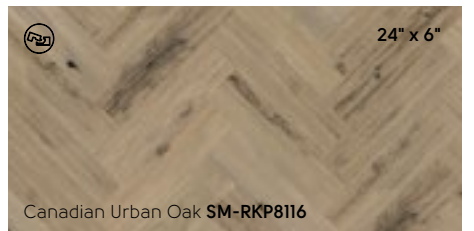
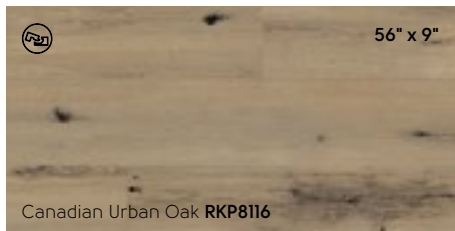
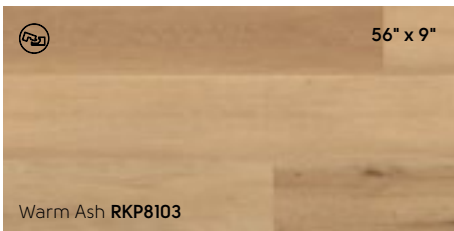

 = available in RIGID CORE product



Dark and Detailed

Braemar Oak RKP8238

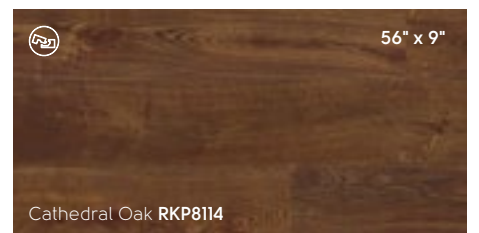
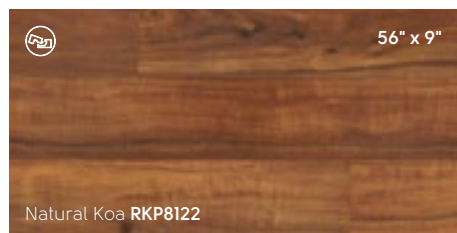
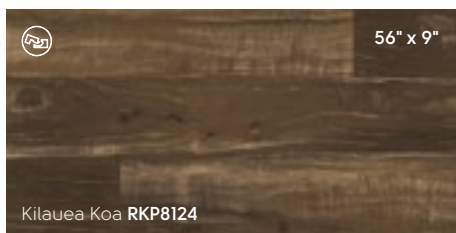
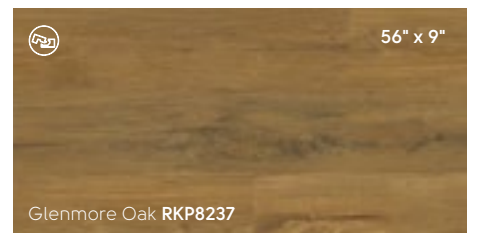
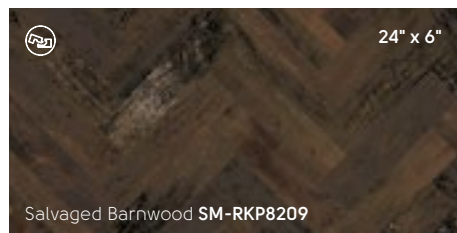
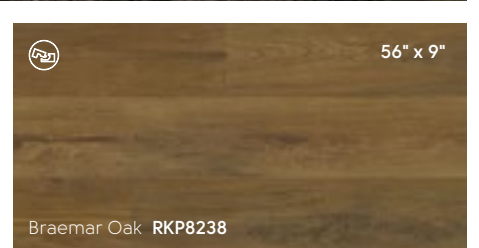



 = available in RIGID CORE product

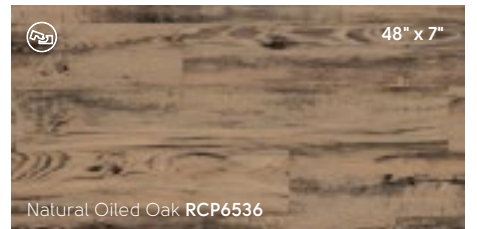
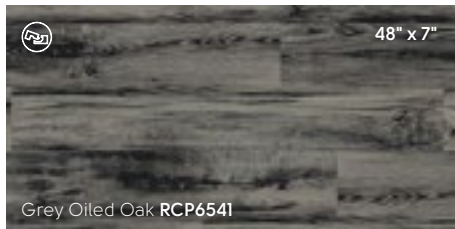

LIMED COASTAL OAK

Tapping into the trends for light and airy neutral tones, Limed Coastal Oak combines the look of worn, sun-bleached driftwood with rustic knot detailing to suit a variety of interiors.

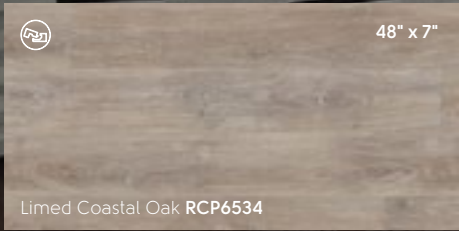

Coastal Cool

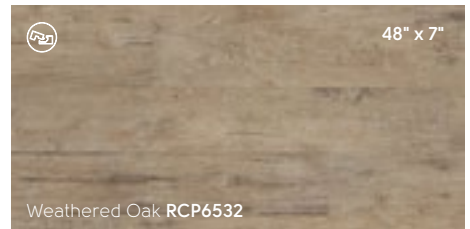
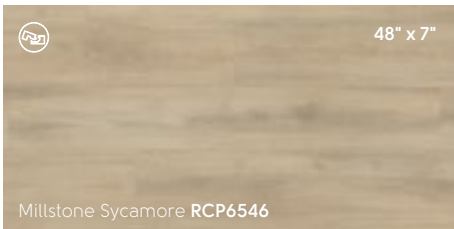

 = available in RIGID CORE product

AGED SPANISH OAK

The linear blend of brown-gray and silvery charcoals come together in this contemporary oak plank. The delicate grain detailing and relatively smooth finish brings modern elegance to any space.



48" x 7"

Aged Spanish Oak RCP6535

*Distressed
Darks*



48" x 7"

Charred Weathered Pine RCP6539

VINTAGE OREGON OAK

The neutral mid-browns of this Pacific Northwest wood make for a timeless design, while the rustic knot detailing and manmade markings add aged character and charm, creating the ideal backdrop for traditional and vintage interiors.

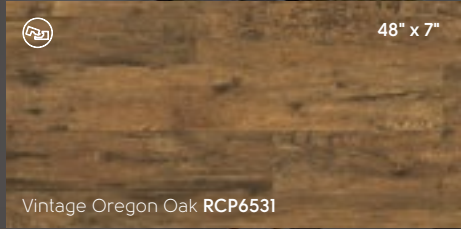

Warm Character

 = available in RIGID CORE product



48" x 7"

Marron Elm **RCP6543**



48" x 7"

North American Oak **RCP6533**



48" x 7"

Smoked American Maple **RCP6545**



Texas White Ash RKP8105



Spend More Time Living, Less Time Cleaning

Karndean Designflooring is durable and easy to look after. Our K-Guard+® enhanced surface treatment helps protect against everyday wear, spills and scuffs, giving you peace of mind that your Karndean floor will look great for years to come.

A regular sweep and mop with Karndean Clean or other pH neutral, fragrance free cleaner approved for use with vinyl floors is all you need to keep your Karndean floor looking its best.

Visit the cleaning and maintenance section of our website where you can watch videos and view answers to frequently asked questions.

www.karndean.com/cleaning



Bring your design ideas to life

Find your nearest recommended retailer

Use our online search feature to find your nearest Karndean Designflooring recommended retailer. Simply enter your ZIP code to see who is in your area.

www.karndean.com/findaretailer

Order free swatch samples

If you need some extra help selecting the best color for your room, visit www.karndean.com or text the product code to 877-722-2086 to ship samples right to your house! These are designed to help you pick which product is right for you. We recommend visiting a local retailer to see the full color and design variation.

www.karndean.com/samples

Color & Pattern Reproduction

All our products are inspired by things we have seen in nature. Just as variation in both color and detail are part of the beauty of nature, so too are some of our designs. This means that with some of our products you will see natural variation when your floor is laid.

We are continually developing new ideas and improving on our existing designs. This does mean that sometimes products are withdrawn at short notice. Karndean Designflooring owns all its designs and are protected by copyright.

Karndean Designflooring owns all their designs and are protected by copyright.



Karndean Designflooring



Corporate Headquarters and Showroom
1100 Pontiac Court
Bushy Run Corporate Park
Export, PA 15632
Phone: 888-266-4343
Fax: 800-887-7043
Email: info@karndean.com

West Coast Distribution and Showroom
423 N. 5th Street
Suite 100
Las Vegas, NV 89030
Fax: 702-248-8534

Central Distribution and Showroom
14201 Sovereign Road
Suite 141
Fort Worth, TX 76155
Fax: 817-553-3920

Karndean Designflooring Canada
#3-3250 Harvester Road
Burlington, Ontario
L7N 3W9
Phone: 866-819-6825
Fax: 905-336-2180



www.karndean.com

Visualize your new floor...



With our Floorstyle digital floor designer! View our entire catalog of products in a variety of room settings or upload a photo of your own space!



www.karndean.com/floorstyle

210709

Front cover: Texas White Ash SM-RKP8105

This image: Glenmore Oak RKP8237